

SHOP NOTE:  
TOE DIRECTION FAR SIDE

Joist Reinforcement was installed under a previous contract

Roof Frame for the future RTU **shall** be installed as part of this work

*Japon Anderson*  
10/28/2020

BILL OF MATERIAL					
LINE #	QTY	PC MARK	DESCRIPTION	LENGTH	WEIGHT TOTAL
ONE 1RF1			FRAME		76
1	1RF1	L4x3x1/4		2 8 1/2	A36 16
2	a34	L4x4x1/4		3 4 1/2	A36 45
1	a33	L4x3x1/4		2 8 1/2	A36 16

BY	DATE	REVISIONS	NO.	DATE
			1.	21 Oct 2020
			2.	
			3.	

JOB NAME: US FORESTRY SCIENCE LAB  
 CONTRACTOR: WMMW  
 ARCHITECT: STANDARD MGMT & ENGINEERING  
 ENGINEER: STANDARD MGMT & ENGINEERING

DETAILING BY: MITCH WHITMIRE  
 678-316-7467  
 SDS/2 LEGAL # gtd4k

21 Oct 2020

AAA WELDING & FABRICATION SERVICE  
 P.O. BOX 81665  
 ATHENS, GEORGIA 30608  
 PHONE: (706) 296-0539

JOB NO.

SHEET NO.

1

PAINT: 1/C RED SHOP PRIMER  
 WELDING ELECTRODES: E70xx  
 SURFACE PREP: SSPC SP2  
 HOLES: 13/16 U.N.O.  
 ALL PC. MARKS ON LEFT END.

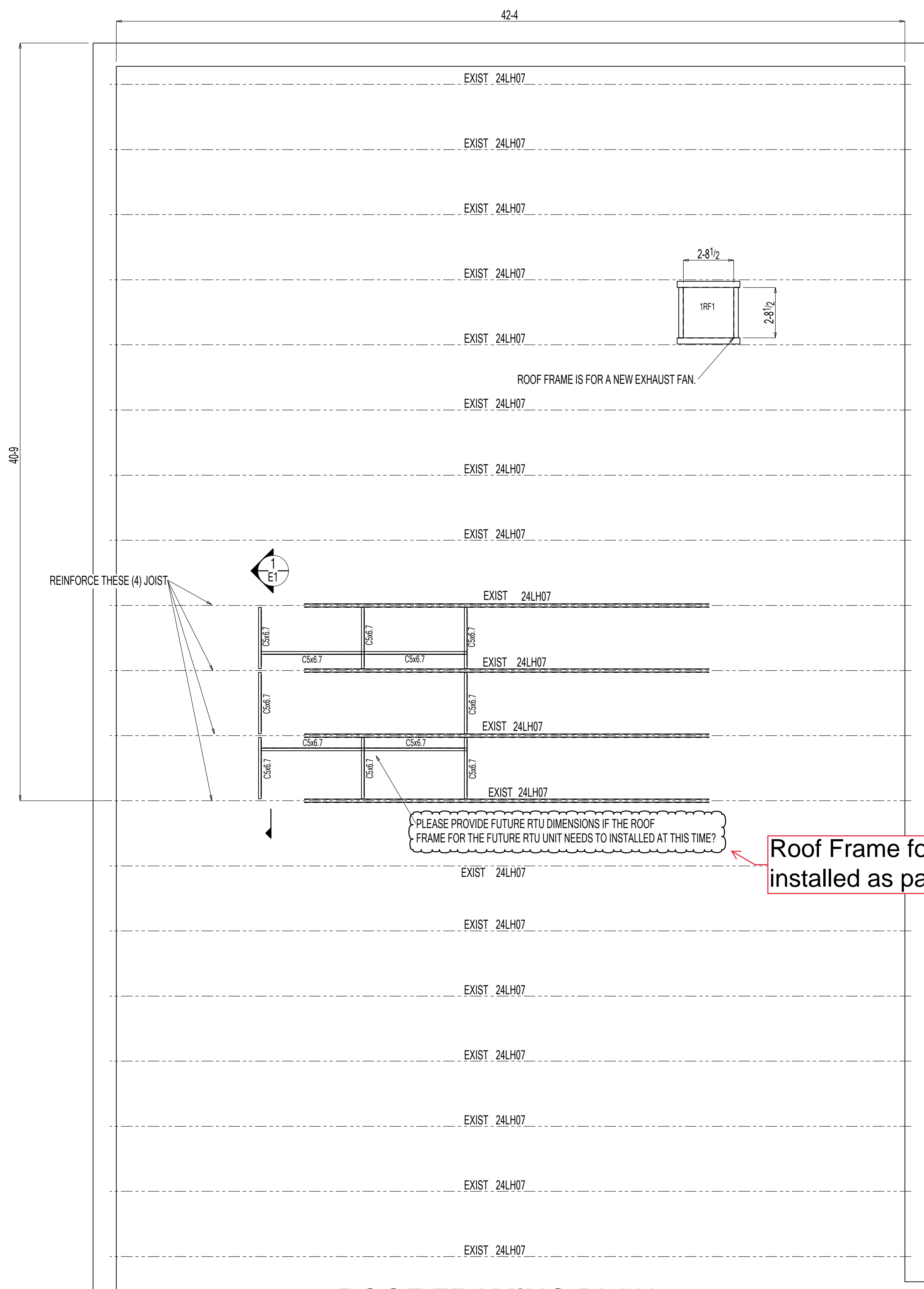

ROOF FRAMING PLAN

Joist Reinforcement was installed under a previous contract

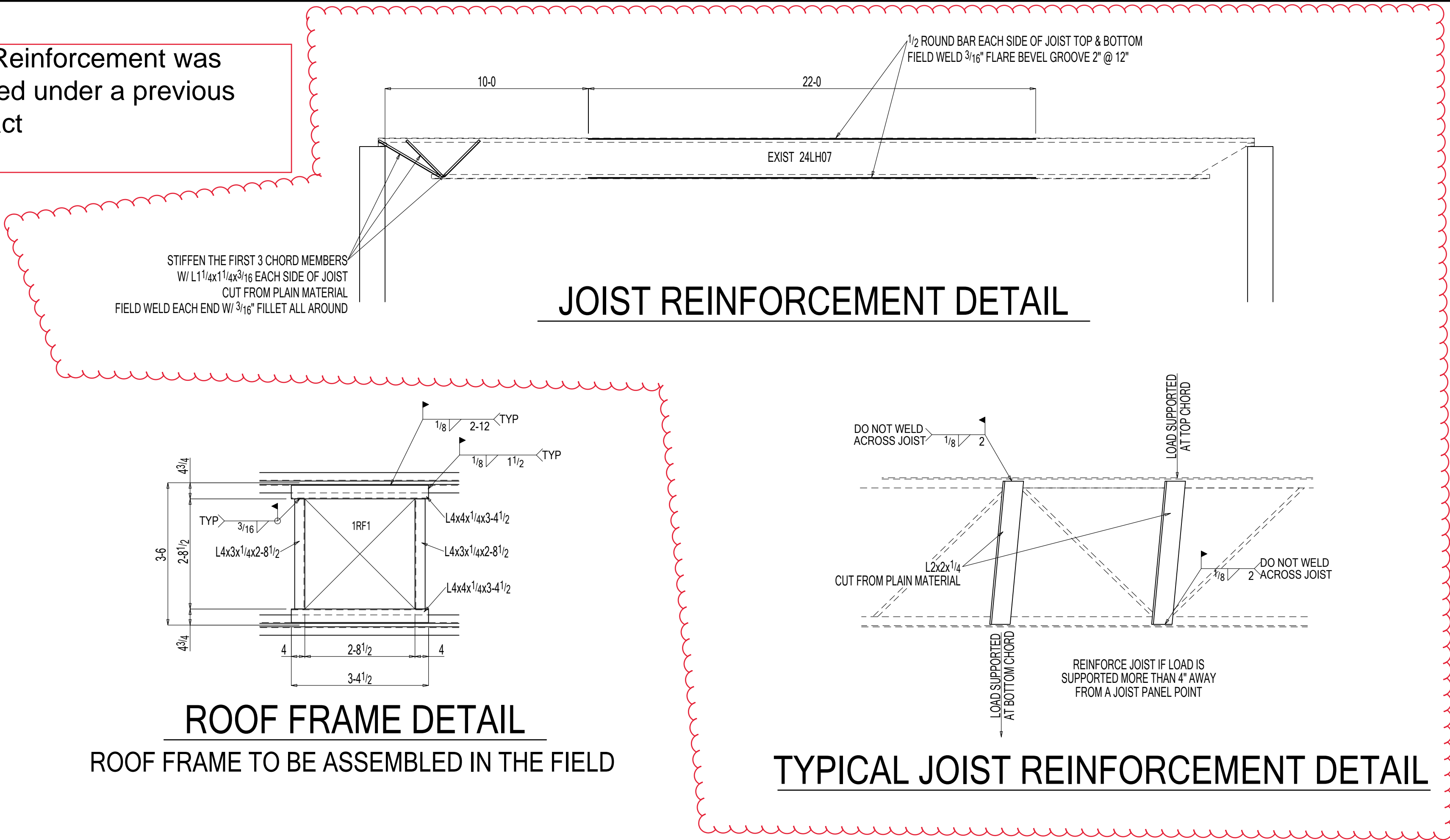

JOIST REINFORCEMENT DETAIL

ROOF FRAME DETAIL  
ROOF FRAME TO BE ASSEMBLED IN THE FIELD

TYPICAL JOIST REINFORCEMENT DETAIL

Roof Frame for the future RTU shall be installed as part of this work

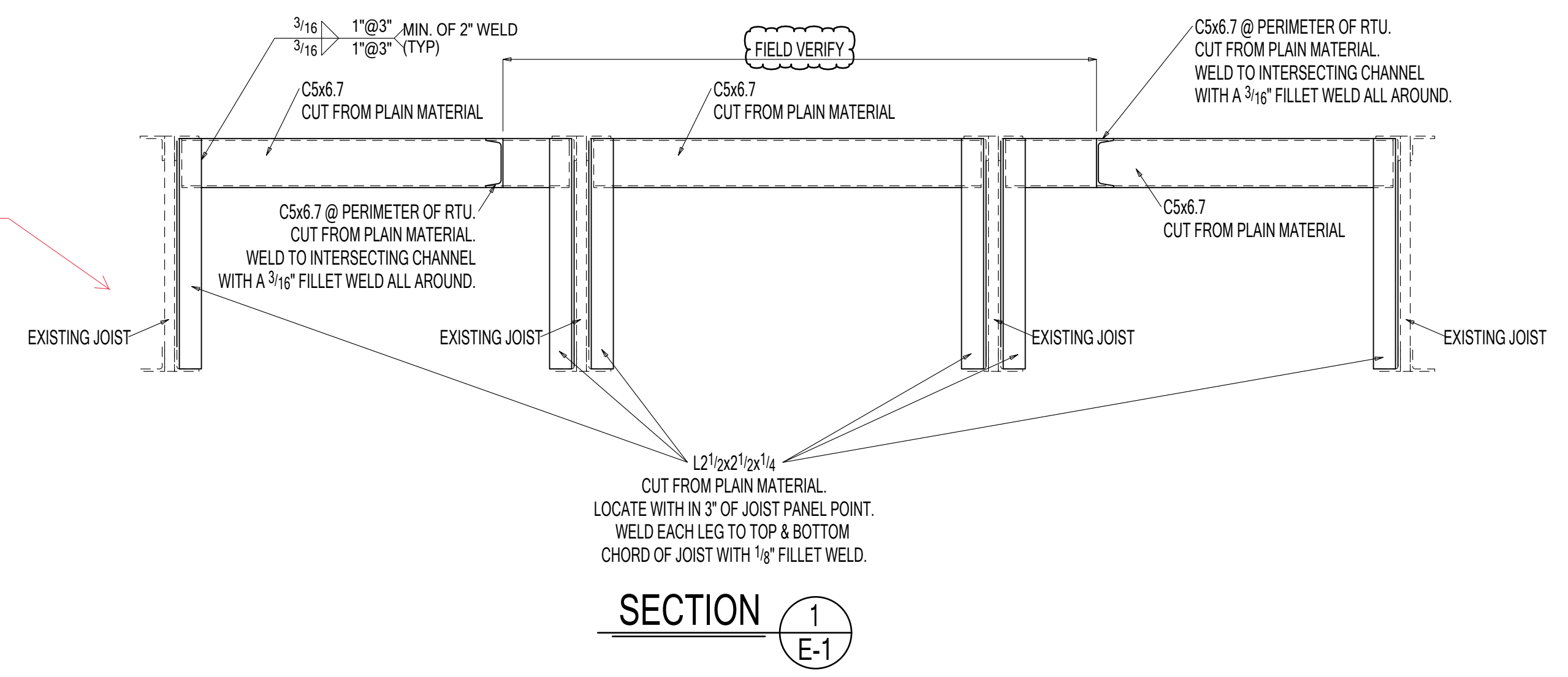

SECTION 1 E-1

BY		DATE	
REVISIONS			
NO.	1.	2.	3.
MMW	21 Oct 2020	CHECKER:	DATE:
DETAILER:	US FORESTRY SCIENCE LAB	CONTRACTOR:	ARCHITECT:
DATE:	21 Oct 2020	ENGINEER:	STANDARD MGMT & ENGINEERING
JOB NAME:	DETAILING BY MITCH WHITMIRE 678-316-7467 SDS/2 LEGAL # gtd4k		
	FOR APPROVAL 21 Oct 2020		
	AAA WELDING & FABRICATION SERVICE P.O. BOX 81665 ATHENS, GEORGIA 30608 PHONE: (706) 296-0339		
	JOB NO.		
	SHEET NO.		
	E-1		